

What happens when the Remote Control Transmitter button is pressed?

1. When the Remote Control Door Button is pushed, the door will start to open. After the door is in the open position, the LED lights on the **CommandLIFT™** motor unit will turn on. The lights will stay on (with the door open) for fifteen minutes.
2. When the Remote Control button is pressed again, the door will close. After the door is in the closed position, the LED lights on the **CommandLIFT™** motor unit will turn on and will stay on for one minute.
3. If you press the Remote Control button while the door is in travel either up or down, the door will STOP. The next time the button is pushed, the door will travel in the opposite direction.
4. If the roll-up door hits an object (such as a box or other cargo) while it is moving, the door will stop moving and reverse its direction approximately three inches allowing the obstacle to be removed. The next time the Remote Control button is pressed, the door will move in the opposite direction.
5. Make sure the roll-up door lock is in the UNLATCHED position before the **CommandLIFT™** is operated.



CommandLIFT™ Maintenance

There are only a few maintenance procedures that should be completed on a **monthly** basis.

1. Using **WHITING®** brand **EASY-UP™** spray lubricant, **completely lubricate** the EMERGENCY key lock located on the Roll-Up door.
2. Inspect and clean the Aluminum track. If the track assembly was shipped in two pieces, make sure the track joint is flush and remove any sharp edges.
3. Make sure the Motor Unit slides smoothly in the track.
4. Check all the wiring connections to make sure they are clean, safe and secure.
5. Check the Plastic Motor Unit Guides and replace them if they show any signs of wear (see below). These Guides are available from a **WHITING®** dealer.
Ask for Plastic Motor Unit Guides
Part No. – CLA-0116 (Set of 4).



Replacing the Plastic Guides on the Motor Unit

1. Remove the **CommandLIFT™** Motor Unit from the aluminum track as per the directions on the next page.
2. Remove the four Plastic Motor Unit Guides from the Motor Unit housing (see figure 2).
3. Inspect the Plastic Motor Unit Guides and replace them if they show any signs of wear.



Figure 2 – Plastic motor unit guides

Motor Unit Removal for Servicing

If the **CommandLIFT™** has to be removed from the track for regular maintenance, follow these steps:

1. Remove the Turn Buckle assembly from the **CommandLIFT™**.
2. Remove the STOP screw from the track at the end furthest from the door opening.
3. Open the black access panel on the motor unit (see figure 3) and you will see a metal lever. Insert a screw driver in the hole on this lever and pull the lever towards the roll-up door.

This will release the motor unit from the gears and will allow the motor unit to slide freely along the track.

4. While the Access Cover is open, remove the EMERGENCY Release Wire Assembly from the motor unit.
5. Remove the plastic End Cap from the Aluminum track at the end furthest from the door opening.
6. Remove the four screws from the black cover on the **CommandLIFT™** Motor Unit and unplug the two LED light wiring harnesses in the Motor Unit (see Figure 4, below).
7. Slide the **CommandLIFT™** Motor Unit out of the aluminum track (see Figure 5, below).
8. To reinstall the **CommandLIFT™**, reverse Steps 1 to 8 (see next page).

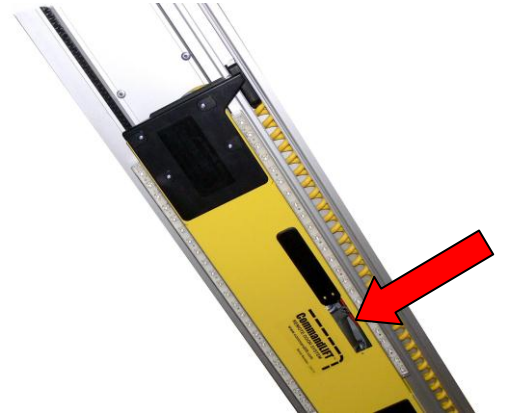

Figure 3 – Access Cover

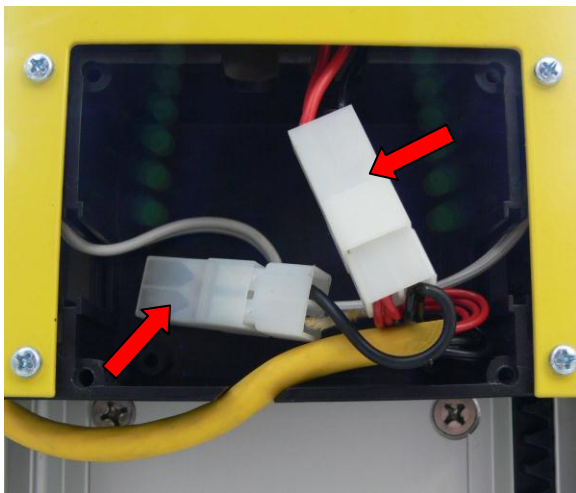

Figure 4 – Unplug wiring

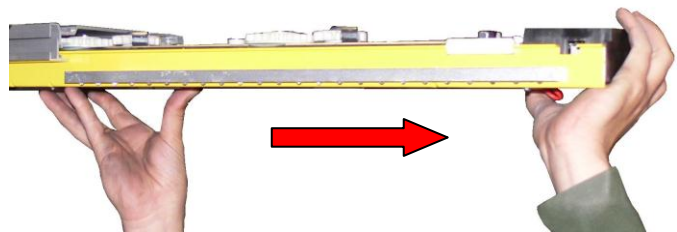

Figure 5 – Remove motor from track

Reinstall Motor Unit

If the **CommandLIFT™** was removed from the track for regular maintenance, complete the following steps to reinstall the **CommandLIFT™** motor unit into the track.

1. Slide the **CommandLIFT™** motor unit back into the end of the aluminum track and reinstall the black End Cap assembly to the aluminum track at the end furthest from the door opening.
2. Plug in the two wiring harnesses that are located in the plastic box on the motor unit (refer to figure 4 on the previous page).
3. Replace the black plastic cover on the motor unit (see figure 6, below). Make sure the tab on the cover fits into the slot on the coil cable slider assembly. Replace the 4 mounting screws.

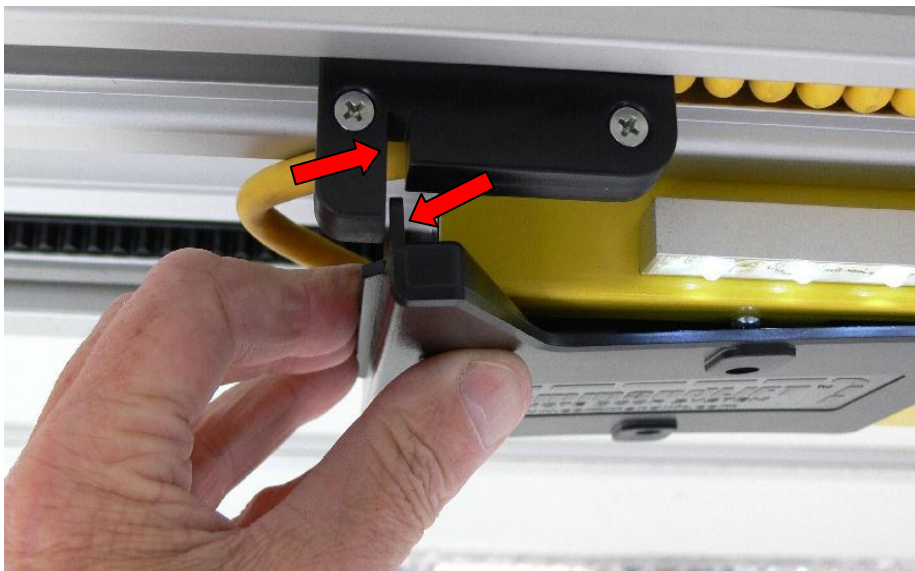

Figure 6 – Replace Cover Plate

4. Open the black access panel on the motor unit (see figure 3 on the previous page) and you will see a metal lever. Insert a screw driver in the hole on this lever and push the lever away from the roll-up door. This will engage the motor unit with the gears and will allow the motor unit to operate the roll-up door. The lever must “SNAP” into place or the gears will not mesh properly.
5. Reinsert the EMERGENCY Release Wire Assembly to the metal lever mentioned in step 4 above. Do NOT operate the door unless the EMERGENCY Release Wire is installed properly.
6. Replace the STOP screw on the track at the end furthest from the door opening.
7. Connect the Turn Buckle assembly to the **CommandLIFT™** and readjust as necessary.

Adjust the door travel

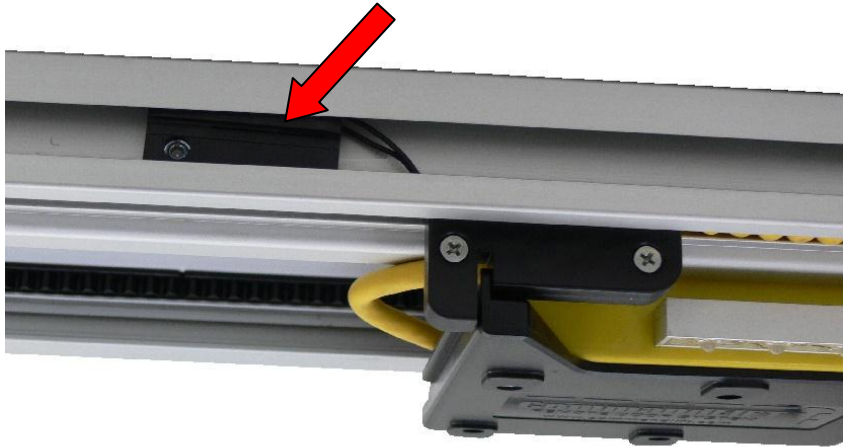

Figure 8 – Sensor Unit

On the road-side of the aluminum track, you will see two Sensor Units that are each held in place with a set screw (see Figure 8). You will have to remove the plastic strip from the aluminum track in order to see these Sensors. These Sensor Units tell the **CommandLIFT™** how far to travel before stopping.

The Sensor for the door **CLOSED** position was preset at the factory and shouldn't require adjustment.

To set the Sensor for the door **OPEN** position, open the door all the way. Loosen the set screw on the **OPEN** Sensor and slide it in the aluminum track. Test the door after each adjustment and continue to adjust the sensor until the door opens and stops at the desired position.

Adjust the Sensors a small amount each time. In the **OPEN** position, the roll-up door should be just clear of the header when it is open. This will provide a **FULL** door opening on the truck body or trailer.

Using the EMERGENCY Key Release system

You may be occasionally required to release the **CommandLIFT™** from the door system in order to operate the Roll-Up door manually. **CommandLIFT™** can be released from the drive system in two ways.

Using the exterior EMERGENCY release

1. Insert the **CommandLIFT™** key into the lock cylinder located in the center of the second roll-up door panel from the top.
2. Turn the key 90 degrees and pull the lock and connecting cable from the lock cylinder. Pull the lock assembly *firmly* and the **CommandLIFT™** will be released from the drive system.
3. Reinsert the cable and the lock cylinder back into the lock housing on the door. The roll-up door can now be operated manually.

Using the interior EMERGENCY release

1. Find the yellow cable section that comes from the drive unit to the door.
2. Pull the yellow section *firmly* and the **CommandLIFT™** will be released from the drive system.

Reconnecting the CommandLIFT™ drive system

1. Open the Access Panel (see figure 3) on the **CommandLIFT™** motor unit.
2. Pull the lever towards the front of the body (away from the door opening) until the lever "**SNAPS**" into place at the location shown to the right. You may have to use a screw driver or other suitable tool to help you move the lever into place. The motor unit is now locked into place in the track. Replace the cover on the access panel. **CommandLIFT™** can now be operated with the Remote Control transmitter.

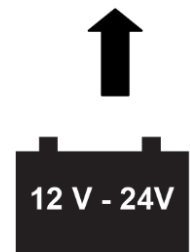

Programming Additional Remote Control Transmitters

The **CommandLIFT™** comes with two Remote Control transmitters that are pre-programmed for your motor unit. The **CommandLIFT™** will allow additional Remote Control transmitters to be programmed to the motor unit. These additional Remote Control transmitters must be programmed into the **CommandLIFT™** system by following these steps:

1. Remove the cover from the **CommandLIFT™** Electronic Command Module.
2. Locate the small **WHITE** button shown with the Red arrow (see Figure 7).
3. Press the **WHITE** button briefly and the small **RED** light will glow.
4. **While the RED light is ON**, press the button on the new Remote Control transmitter. Press this button again and the **RED** light will go out, and the new transmitter is programmed for your motor unit. Press the button again and the door will operate

You can also erase the **CommandLIFT™** memory of all the programmed transmitters and re-program a new set of transmitters by following these steps: Press and hold the **WHITE** button approximately 10 seconds. Release the button and the small **RED** light will flash 5 times. All memory of existing transmitters has been erased. Follow Steps 2 to 4 above and the new transmitters will be programmed for your system.

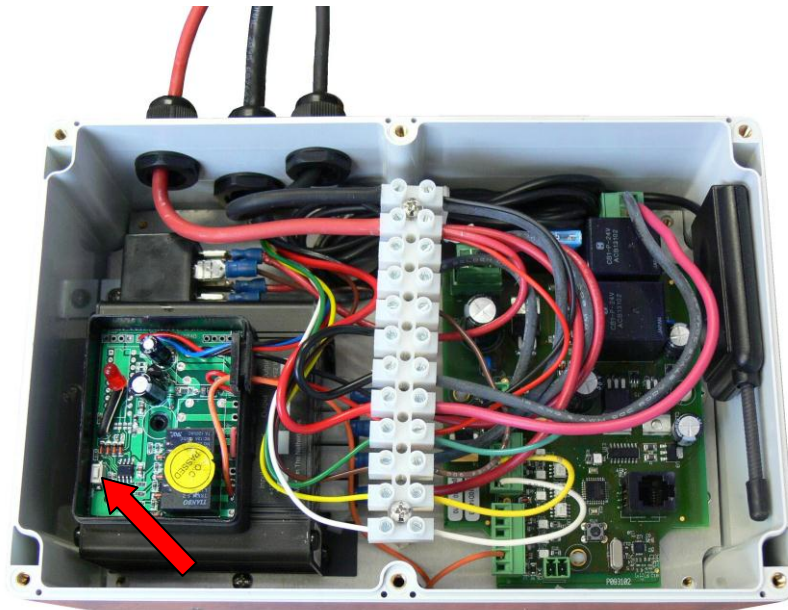

Figure 7 – Programming Button

Electronic Command Module shown with Cover Removed

Changing the Battery in the Remote Control Transmitter

If the Roll-Up door does not operate when the button on the remote control transmitter is pressed, check the blue light on the transmitter to make sure it is working. If the blue light flashes, is dim or does not light at all, then the battery in the transmitter needs to be replaced.



1. Using a small Phillips screwdriver, carefully remove the three small screws from the back of the transmitter housing and remove the rear cover of the transmitter.



2. With the cover removed, you will see the two CR2016 button cell batteries. Carefully remove the batteries from the transmitter and replace them. Make sure to replace the batteries in the same orientation as they were removed. + facing up.
3. After replacing the cover, confirm that the Blue light on the on the transmitter is working properly. The Remote Control does NOT need to be reprogrammed.

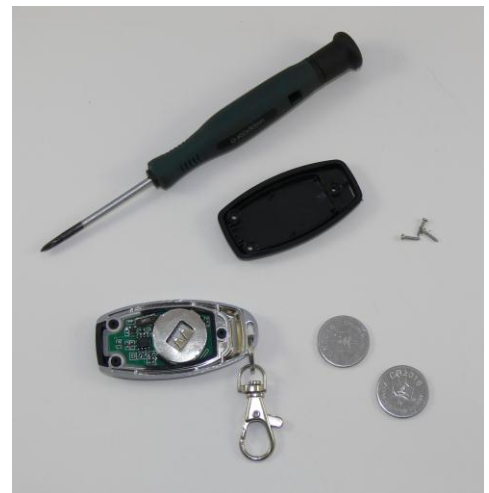

WHITING® Roll-Up Door Maintenance Procedure

Lubricate the roller bearings and shafts, hinge pins and cable drum bearings as per the illustrations below.



DO NOT USE GREASE OF ANY KIND!

Grease sits on the surfaces and attracts dust, dirt and salt. The recommended lubricant is environmentally friendly, **WHITING®** brand **EASY-UP™** spray lubricant available from your local **WHITING®** dealer



Twin Spring Balancer Maintenance

The **CommandLIFT™** was designed to operate with any **WHITING®** roll-up door, provided the door is equipped with a twin spring balancer and the door has been properly maintained and balanced. The **CommandLIFT™** can also be used with other roll-up door systems but some modifications to the trailer or truck body header may be required.

Check to make sure the roll-up door is properly balanced.

The **CommandLIFT™** will operate the roll-up door provided a force of no more than 50 pounds is required to open or close the door.

If the door requires more force to open than it does to close, increase the tension on the balancer.

If the door requires more force to close than it does to open, decrease the tension on the balancer.

Time and the elements affect the tension on the spring that lifts the door. Over time, the spring wire will corrode and loose effective wire diameter. The springs themselves also get tired and loose their tensile strength.

An average balancer on a **WHITING®** door will last approximately 15,000 to 25,000 cycles.

If your roll-up door is NOT in proper balance, follow the procedure on the next page.



Figure 1 – Adjusting the door balancer

Adjusting and Maintaining The Proper Door Balance

Always lubricate your roll-up door using **WHITING® Easy-UP™** spray lubricant prior to checking the balance of the door. Refer to the section on Door Maintenance.

NOTE: If the door is balanced before it is lubricated, it will have to be “over balanced” in order to overcome the friction of dry rollers and hinge pins.

1. Fully open the roll-up door and push it back towards the front of the trailer approximately 18”, this may require the assistance of another person or a spreader bar placed between the header and the bottom panel of the door.
2. Install vice-grip pliers into the track at the bottom roller to hold the door in this open position while working on the balancer.
3. The springs should have equal tension, for this reason it is important to count the number of turns either put on or removed from each spring, this is easily done by placing a mark on the winding anchor before doing any adjustments.
4. Insert a 3/8” diameter rod (*see Figure 1 – previous page*) into one of the holes on the winding cone and carefully loosen the set screws. Lower the winding bar to add tension or raise the winding bar to remove tension. Insert the second winding bar into the next hole on the winding anchor and repeat the process until the desired tension is achieved. The amount of tension to be added or removed depends on the type of door, the age of balancer and how far out of adjustment it is. Adjust the springs no more than one half turn at a time.
5. Tighten all the set screws and remove the winding bars
6. Repeat this procedure on the other Balancer spring. Be sure to add or remove the same amount of tension as you did on the first side.
7. Remove vice-grip pliers from track and test the door operation.

WHITING® Door Manufacturing

CommandLIFT™ Automatic, Remote, Roll-Up Door Opener is guaranteed against defective material and workmanship for a period of one (1) year from date of purchase and provided the **CommandLIFT™** is only installed on a **WHITING®** Roll-Up door.

This warranty shall apply to defects in materials and workmanship for structural components of the opener. Certain motor components, including, but not limited to, motor unit slides and motor assemblies are subject to wear and tear that is beyond the control of the manufacturer. In the event of abuse to, or alteration of, any component, this warranty shall be void. Failure to follow proper maintenance procedures shall be considered as abuse and will void this warranty.

Any warranty claim must be arranged with a **WHITING®** company official prior to the work being started. In order to expedite the necessary authorization, please obtain the following information and contact **WHITING®** via phone, fax or e-mail.

1. The nature of the problem and the work required to correct the problem
2. The **CommandLIFT™** Serial Number
3. Any other door information available

The claim will be assessed upon receipt of the above information. A written Warranty Approval will be issued for any approved claim. This written Approval must be supplied to the authorized service centre prior to the work being performed and must also be submitted with the final claim. No unauthorized claims will be allowed and under no circumstances may the claim exceed the approved amount.

WHITING® has authorized service centers across North America. Any approved Warranty work must be performed by skilled persons at a **WHITING®** authorized service centre. Delivery of the unit to the approved service centre and return of the unit to the customer is the responsibility of the customer.

The **CommandLIFT™** Serial Number is located on the front face of the motor unit. **WHITING® Door Manufacturing Limited** will not be responsible for personal injuries or other damages arising out of the use of parts not meeting **WHITING®** standards of quality. All Warranty Work Must Be Pre-Approved.

This device complies with Part 15 of the FCC Rules. Operation is subject to the following two conditions:

- (1) this device may not cause harmful interference, and
- (2) this device must accept any interference received, including interference that may cause undesired operation.